

Service Manual

H-CDM8065

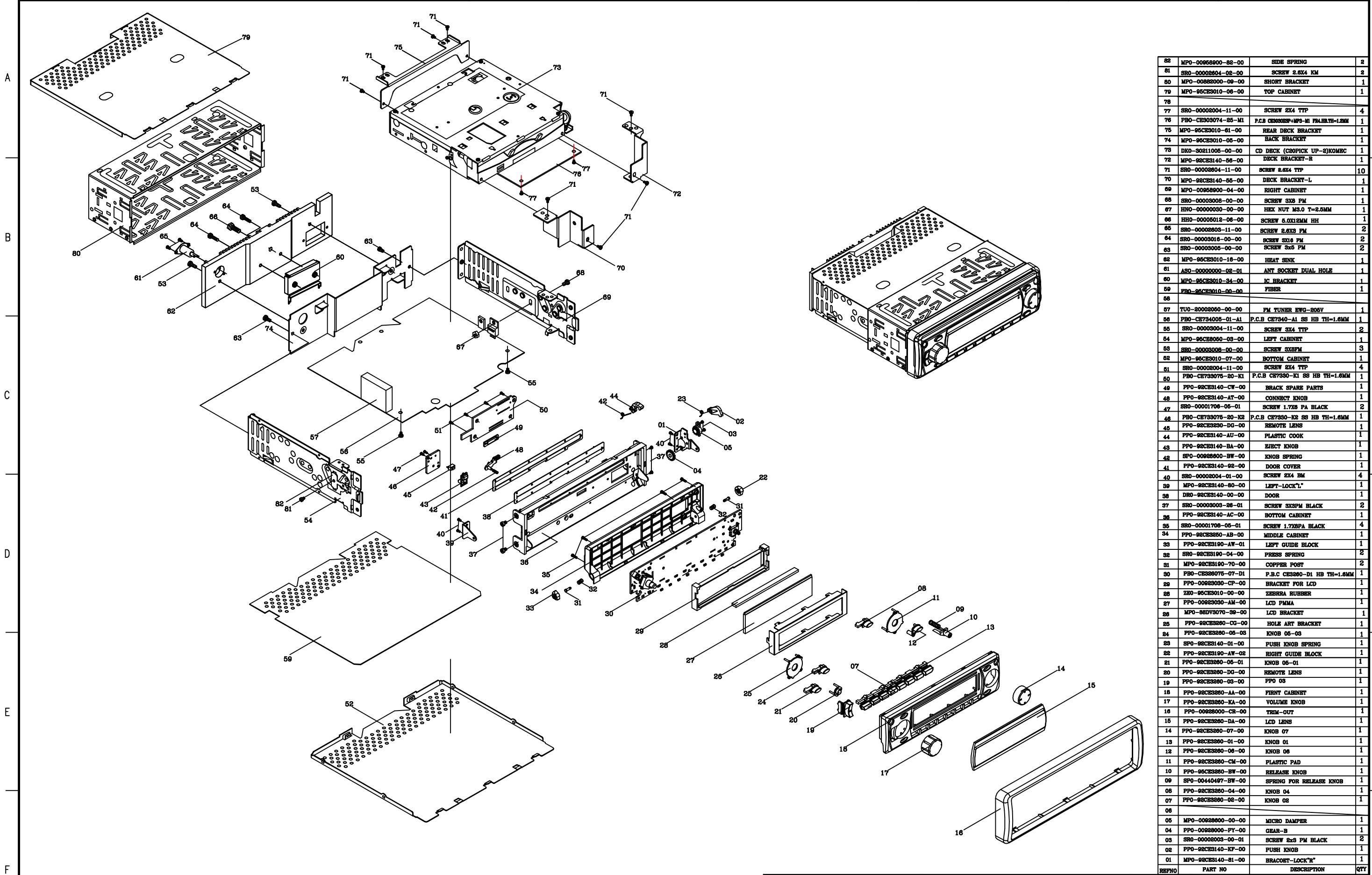

82	MPO-0086800-88-00	SIDE SPRING	2
81	SRO-00002004-02-00	SCREW 2.6X4 KM	2
80	MPO-00882000-09-00	SHORT BRACKET	1
79	MPO-95CE3010-06-00	TOP CABINET	1
78			
77	SRO-00002004-11-00	SCREW 2X4 TTP	4
76	PBO-CE730074-25-M1	P.C.B CEM80SP-MP3-M FM/HTH-1.6MM	1
75	MPO-95CE3010-61-00	REAR DECK BRACKET	1
74	MPO-95CE3010-05-00	BACK BRACKET	1
73	DKO-30211005-00-00	CD DECK (C20PICK UP-2)KOMEC	1
72	MPO-92CE3140-56-00	DECK BRACKET-R	1
71	SRO-00002004-11-00	SCREW 2.6X4 TTP	10
70	MPO-92CE3140-55-00	DECK BRACKET-L	1
69	MPO-00858900-04-00	RIGHT CABINET	1
68	SRO-00003008-00-00	SCREW 3X8 PM	1
67	HNO-00000030-00-00	HEX NUT M3.0 T=2.5MM	1
66	HNO-00006012-06-00	SCREW 5.0X12MM HH	1
65	SRO-00002803-11-00	SCREW 2.6X3 PM	2
64	SRO-00003016-00-00	SCREW 3X16 PM	2
63	SRO-00003005-00-00	SCREW 3x5 PM	2
62	MPO-95CE3010-16-00	HEAT SINK	1
61	ASO-00000000-02-01	ANT SOCKET DUAL HOLE	1
60	MPO-95CE3010-34-00	IC BRACKET	1
59	PBO-95CE3010-00-00	FIBER	1
58			
57	TUO-20002050-00-00	FM TUNER EWG-205V	1
56	PBO-CE734005-01-A1	P.C.B CE7340-A1 SS HB TH=1.6MM	1
55	SRO-00003004-11-00	SCREW 3X4 TTP	2
54	MPO-95CE3000-03-00	LEFT CABINET	1
53	SRO-00003008-00-00	SCREW 3X8PM	3
52	MPO-95CE3010-07-00	BOTTOM CABINET	1
51	SRO-00002004-11-00	SCREW 2X4 TTP	4
50	PBO-CE733075-20-K1	P.C.B CE7330-K1 SS HB TH=1.6MM	1
49	PPO-92CE3140-CW-00	BRACK SPARE PARTS	1
48	PPO-92CE3140-AT-00	CONNECT KNOB	1
47	SRO-00001706-05-01	SCREW 1.7X6 PA BLACK	2
46	PBO-CE733075-20-K2	P.C.B CE7330-K2 SS HB TH=1.6MM	1
45	PPO-92CE3290-DG-00	REMOTE LENS	1
44	PPO-92CE3140-AU-00	PLASTIC COOK	1
43	PPO-92CE3140-BA-00	EJECT KNOB	1
42	SPO-00828000-BW-00	KNOB SPRING	1
41	PPO-92CE3140-92-00	DOOR COVER	1
40	SRO-00002004-01-00	SCREW 2X4 BM	4
39	MPO-92CE3140-80-00	LEFT-LOCK"L"	1
38	DR0-92CE3140-00-00	DOOR	1
37	SRO-00003003-26-01	SCREW 3X3PM BLACK	2
36	PPO-92CE3140-AC-00	BOTTOM CABINET	1
35	SRO-00001706-05-01	SCREW 1.7X6PA BLACK	4
34	PPO-92CE3260-AB-00	MIDDLE CABINET	1
33	PPO-92CE3190-AW-01	LEFT GUIDE BLOCK	1
32	SRO-92CE3190-04-00	PRESS SPRING	2
31	MPO-92CE3190-70-00	COPPER POST	2
30	PBO-CE326075-07-D1	P.B.C CE3260-D1 HB TH=1.6MM	1
29	PPO-00828030-CP-00	BRACKET FOR LCD	1
28	ZEO-95CE3010-00-00	ZEBRRA RUBBER	1
27	PPO-00828030-AM-00	LCD PMMA	1
26	MPO-88DV3070-39-00	LCD BRACKET	1
25	PPO-92CE3260-CO-00	HOLE ART BRACKET	1
24	PPO-92CE3260-05-03	KNOB 05-03	1
23	SPO-92CE3140-01-00	PUSH KNOB SPRING	1
22	PPO-92CE3190-AW-02	RIGHT GUIDE BLOCK	1
21	PPO-92CE3260-06-01	KNOB 06-01	1
20	PPO-92CE3260-DG-00	REMOTE LENS	1
19	PPO-92CE3260-03-00	PPO 03	1
18	PPO-92CE3260-AA-00	PRINT CABINET	1
17	PPO-92CE3260-KA-00	VOLUME KNOB	1
16	PPO-00828000-CR-00	TRIM-OUT	1
15	PPO-92CE3260-DA-00	LCD LENS	1
14	PPO-92CE3260-07-00	KNOB 07	1
13	PPO-92CE3260-01-00	KNOB 01	1
12	PPO-92CE3260-06-00	KNOB 06	1
11	PPO-92CE3260-CM-00	PLASTIC PAD	1
10	PPO-95CE3260-BW-00	RELEASE KNOB	1
09	SPO-00440497-BW-00	SPRING FOR RELEASE KNOB	1
08	PPO-92CE3260-04-00	KNOB 04	1
07	PPO-92CE3260-02-00	KNOB 02	1
06			
05	MPO-00828000-00-00	MICRO DAMPER	1
04	PPO-00828000-PY-00	GEAR-B	1
03	SRO-00002003-00-01	SCREW 2x3 PM BLACK	2
02	PPO-92CE3140-KP-00	PUSH KNOB	1
01	MPO-92CE3140-B1-00	BRACKET-LOCK"R"	1
REFNO	PART NO	DESCRIPTION	QTY

NOTE :
UNLESS OTHERWISE SPECIFIED :
1. TOLERANCE : 0 - 50 mm ± 0.10
50 - 100 mm ± 0.15
OVER 100 mm ± 0.20
ANGLE 0 - 0.5 DEG.
2. ALL DIMENSIONS ARE IN mm.
3. BREAK ALL SHARP CORNERS.
4. FOR SHEET METAL PARTS, BURRS < 0.04
& < 0.06 AT FINAL CUT OFF PORTION

MODEL
3280HRF+MP3+ESP+RDS+Y4(7CE734D-A1??)EXPLODE VIEW
PART NO.
REV
A

CHECKED BY
DATE 2005.09.27

AUDITING BY
DATE

APPROVED BY
DATE

DRAWN BY
DATE 2005.09.27

FILE NAME

SCALE NONE
SHEET 1 OF 1

SIZE A2
FINISH

QTY 1

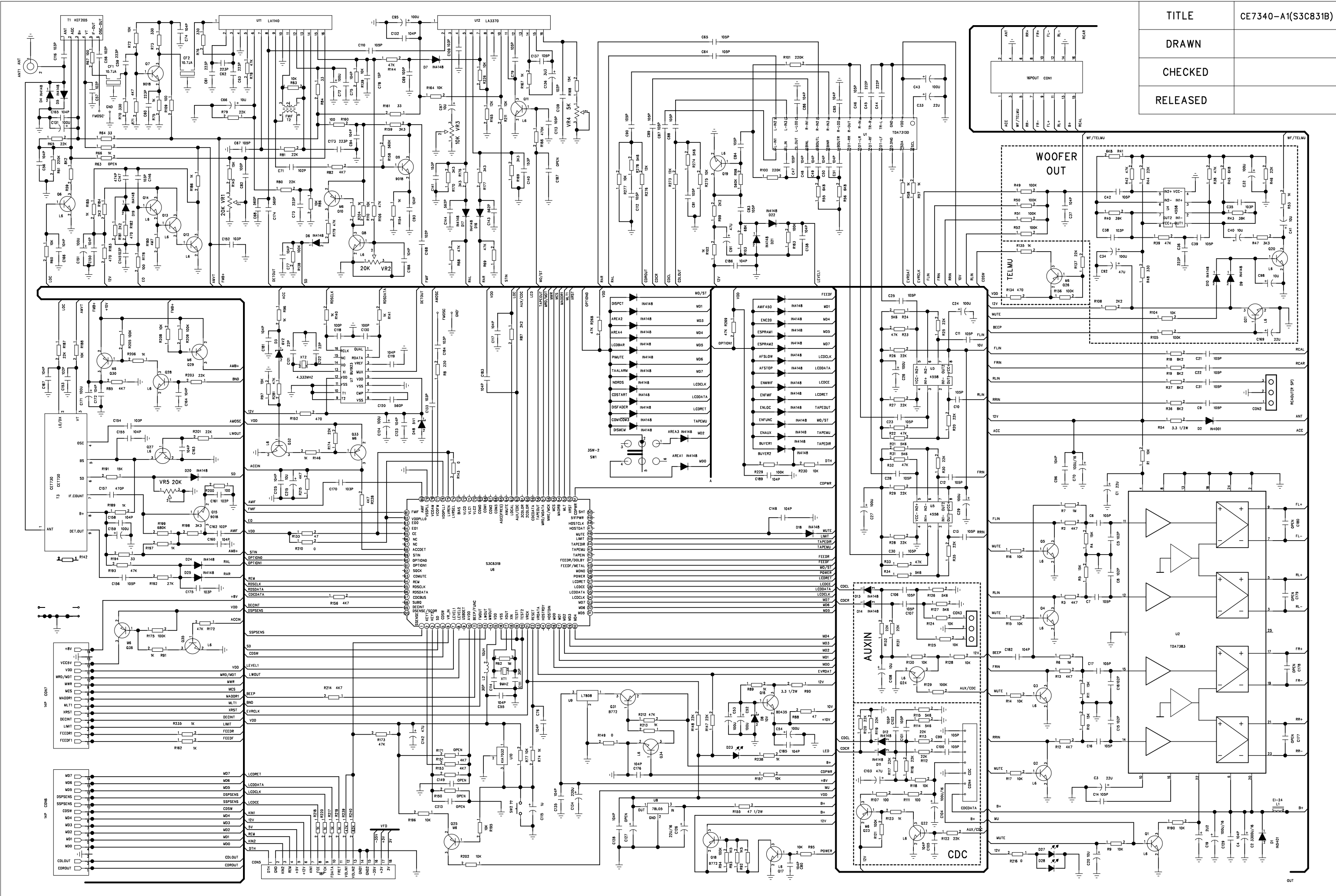

TITLE	CE7340-A1(S3C831B)
DRAWN	
CHECKED	
RELEASED	