

## 5. Identifying and disassembling the parts

### To remove shelves in the freezing compartment

- First remove the icemaking molds. Tilt the shell up at front, then lift it up pull it out of the tracks.

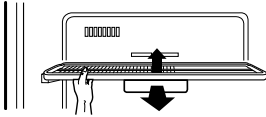

### To remove bio deodorizer

- While pushing the front end knob of the bio deodorizer, pull it downward to disengage.

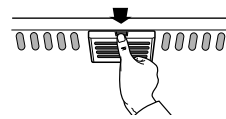

### To remove shelves in the refrigerating compartment

- Hold the shelf by the front and pull it forward of the rack.

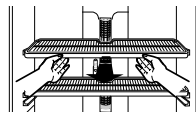

### To remove shelves in the chilled compartment

- Lift up the cover, push the cover to the right (as shown) until the mounting hook(1) disengages, then disengage the other mounting hook (2) and pull out the cover.
- Pull the shelf forward until it stops. then lift it up and pull it out.

#### Disassemble

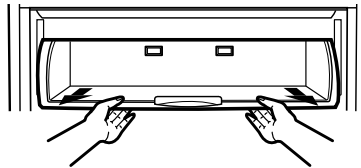
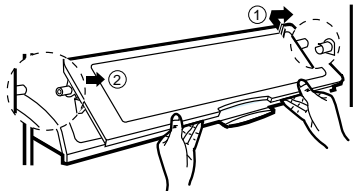

#### Reassemble

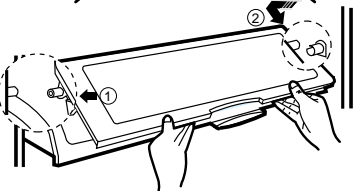
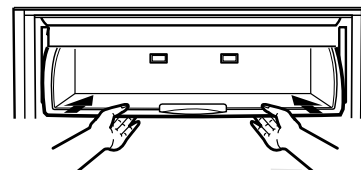

### To remove door bins

- While pushing the bin to the left, lift it up to disengage.

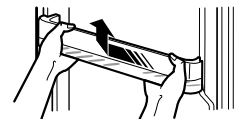

### To remove storage drawers and covers

- Lift up to remove the cover. Pull the drawer half way out, then lifting it up, pull it out completely.

